

# Technical data sheet

## Type X3777V

Ball valve

Xoline for industry

### Applications and special features



- 3-piece ball valve
- Full bore
- Handle can be locked in open or closed position.
- Industry, high pressure, high temperature, high performance industrial applications.
- BSP female threaded connection.

### Technical description

DN	PFA	PS - bar				Cat.	References	Vvs-nr
		L1	L2	G1	G2			
1/4	8	63	63	63	63	3.3	149B 6041V	
3/8	10	63	63	63	63	3.3	149B 6042V	
1/2	15	63	63	63	63	3.3	149B 6043V	
3/4	20	63	63	63	63	3.3	149B 6044V	
1	25	63	63	63	63	3.3	149B 6045V	
1 <sup>1/4</sup>	32	63	63	63	63	II	149B 6046V	
1 <sup>1/2</sup>	40	63	63	63	63	II	149B 6047V	
2	50	40	40	40	40	II	149B 6048V	
2 <sup>1/2</sup>	65	25	25	25	25	II	149B 6049V	
3	80	25	25	25	25	II	149B 6050V	
4	100	25	25	25	25	II	149B 6051V	

#### Important notice :

The indicated pressure for the different categories of fluids (L1/L2/G1/G2) is under no condition a guarantee of use. Therefore, it is essential to validate the use of products under given operating conditions.

- **Connection** : Female/Female, BSP threaded
- **Permissible operating pressure PFA - water-** (for supply, distribution and disposal of water) : See table
- **Maximum permissible pressure PS - other mediums** : See table
- **θ** Mini. : see diagram on reverse  
Maxi. : see diagram on reverse
- **Mediums** : various fluids, water
- **Approvals** : PED 97/23/CE
- **International construction Standards** : CE Conformity Directive 97/23/CE

### Overall dimensions

DN		A	B	C	D	Weight
"	mm	mm	mm	mm	mm	kg
1/4	8	11	65	94	52	0,40
3/8	10	12,5	65	94	52	0,40
1/2	15	15	70	94	53	0,68
3/4	20	20	80	94	56,5	0,96
1	25	25,4	90	111	65,5	1,35
1 <sup>1/4</sup>	32	32	109	111	71	2,50
1 <sup>1/2</sup>	40	38	125	167	89	3,00
2	50	50	146	167	97,5	4,50
2 <sup>1/2</sup>	65	65	178	243	128,5	8,00
3	80	80	205	243	139	14,20
4	100	100	231	274	167,5	21,50

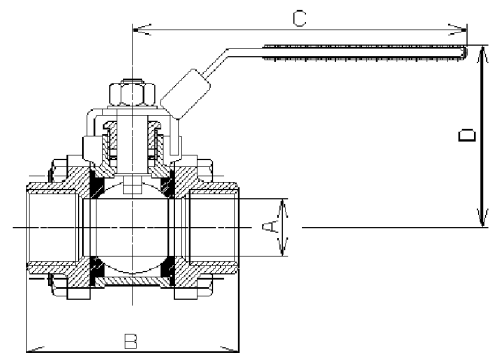

## Technical data sheet    Type X3777V - Ball valve

### Spare parts list and materials

Nb	Description	Materials	EURO	ANSI
1	CASING	Stainless steel	GX5Cr-NiMo19-11-2	ASTM A 351-CF8M
2	SCREW / NUT	Stainless steel	X5Cr-Ni18-10	AISI 304
3	SEAT	PTFE , 25% of glass fibre		
4	BALL	Stainless steel	GX5Cr-NiMo19-11-2	ASTM A 351-CF8M
5	COUNTER FLANGE	Stainless steel	GX5Cr-NiMo19-11-2	ASTM A 351-CF8M
6	STUFFING BOX	Stainless steel	X5Cr-Ni18-10	AISI 304
7	STEM	Stainless steel	X5Cr-NiMo17-12-2	ASTM A 276 / 316
8	WASHER	Stainless steel	X5Cr-Ni18-10	AISI 304
9	NUT	Stainless steel	X5Cr-Ni18-10	AISI 304
10	HANDLEVER	Stainless steel	X5Cr-Ni18-10	AISI 304/PVC

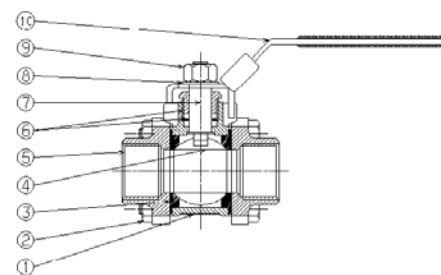

### Working principle

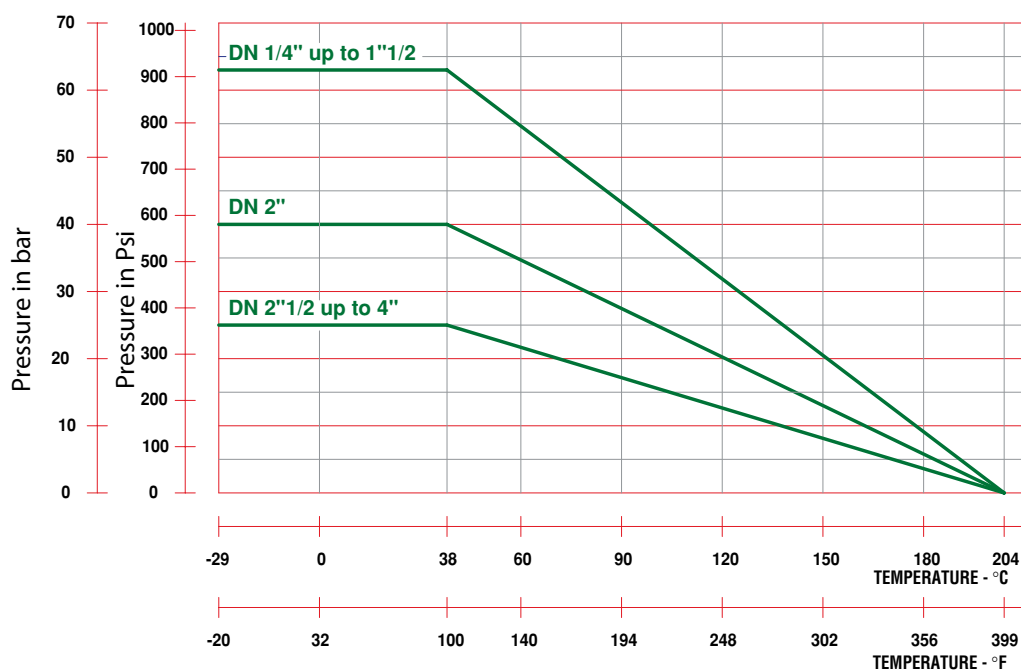

Socla can accept no responsibility for possible errors in catalogue, brochures and other printed material. Socla reserve the right to alter its products without notice. This also applies to products already agreed. All trademarks in this material are the property of the respective companies. All right reserved.

### Socla SAS

365 rue du lieutenant Putier  
71530 VIREY LE GRAND  
Postal address : BP 10273  
71107 CHALON SUR SAONE Cedex

Tel : 33 3 85 97 42 52  
Fax : 33 3 85 97 97 42  
<http://www.socla.com>  
e-mail: [commerfr@socla.com](mailto:commerfr@socla.com)