

Technical data sheet

Type X3444S

Ball valve

Xoline for industry

Applications and special features



- 3-piece ball valve
- Full bore
- Handle can be locked in open or closed position.
- Industry, high pressure, high temperature
- Socket welding connection ends.

Technical description

DN	PFA	PS en bar				Cat.	References	Vvs-nr
		en bar	L1	L2	G1			
1/4	8	63	63	63	63	3.3	149B 6052S	
3/8	10	63	63	63	63	3.3	149B 6053S	
1/2	15	63	63	63	63	3.3	149B 6054S	
3/4	20	63	63	63	63	3.3	149B 6055S	
1	25	63	63	63	63	3.3	149B 6056S	
1 ^{1/4}	32	63	63	63	63	II	149B 6057S	
1 ^{1/2}	40	63	63	63	63	II	149B 6058S	
2	50	40	40	40	40	II	149B 6059S	
2 ^{1/2}	65	25	25	25	25	II	149B 6060S	
3	80	25	25	25	25	II	149B 6061S	
4	100	25	25	25	25	II	149B 6062S	

Important notice :

The indicated pressure for the different categories of fluids (L1/L2/G1/G2) is under no condition a guarantee of use. Therefore, it is essential to validate the use of products under given operating conditions.

- **Connection** : Socket welding connection ends
- **Permissible operating pressure PFA - water-** (for supply, distribution and disposal of water) : See table
- **Maximum permissible pressure PS - other mediums :** See table
- **θ :** Mini. : see diagram on reverse
Maxi. : see diagram on reverse
- **Mediums :** various fluids, water
- **Approvals :** PED 97/23/CE
- **International construction Standards :** CE Conformity Directive 97/23/CE

Overall dimensions

DN		A	B	C	D	F	Weight
"	mm	mm	mm	mm	mm	mm	kg
1/4	8	11	65	94	52	14,2	0,40
3/8	10	12,5	65	94	52	17,6	0,40
1/2	15	15	70	94	53	21,8	0,68
3/4	20	20	80	94	56,5	27,2	0,96
1	25	25,4	90	111	65,5	33,9	1,35
1 ^{1/4}	32	32	109	111	71	42,7	2,50
1 ^{1/2}	40	38	125	167	89	48,8	3,00
2	50	50	146	167	97,5	61,2	4,50
2 ^{1/2}	65	65	178	243	128,5	77	8,00
3	80	80	205	243	139	89,8	14,20
4	100	100	231	274	167,5	115,2	21,50

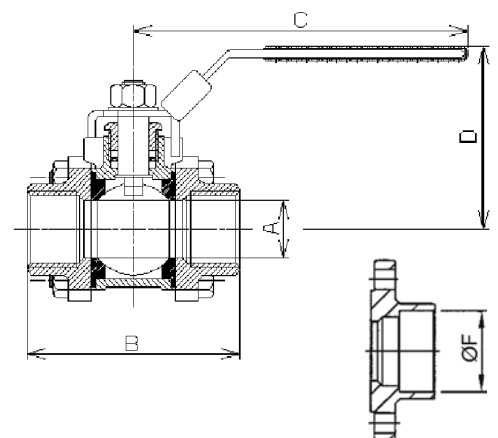

Technical data sheet Type X3444S - Ball valve

Spare parts list and materials

Nb	Description	Materials	EURO	ANSI
1	CASING	Carbon steel		ASTM A216 WCB
2	SCREW / NUT	Carbon steel		ASTM A216 WCB
3	SEAT	PTFE 25% of glass fibre		
4	BALL	Stainless steel	X5Cr-Ni18-10	ASTM A351 CF8
5	COUNTER FLANGE	Carbon steel		ASTM A216 WCB
6	STUFFING BOX	Stainless steel	X5Cr-Ni18-10	AISI 304
7	STEM	Stainless steel	X5Cr-Ni18-10	AISI 304
8	WASHER	Stainless steel	X5Cr-Ni18-10	AISI 304
9	NUT	Stainless steel	X5Cr-Ni18-10	AISI 304
10	HANDLEVER	Zinc coated steel/PVC		

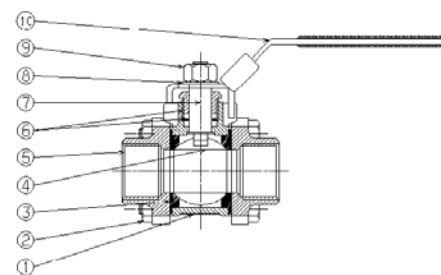

Working principle

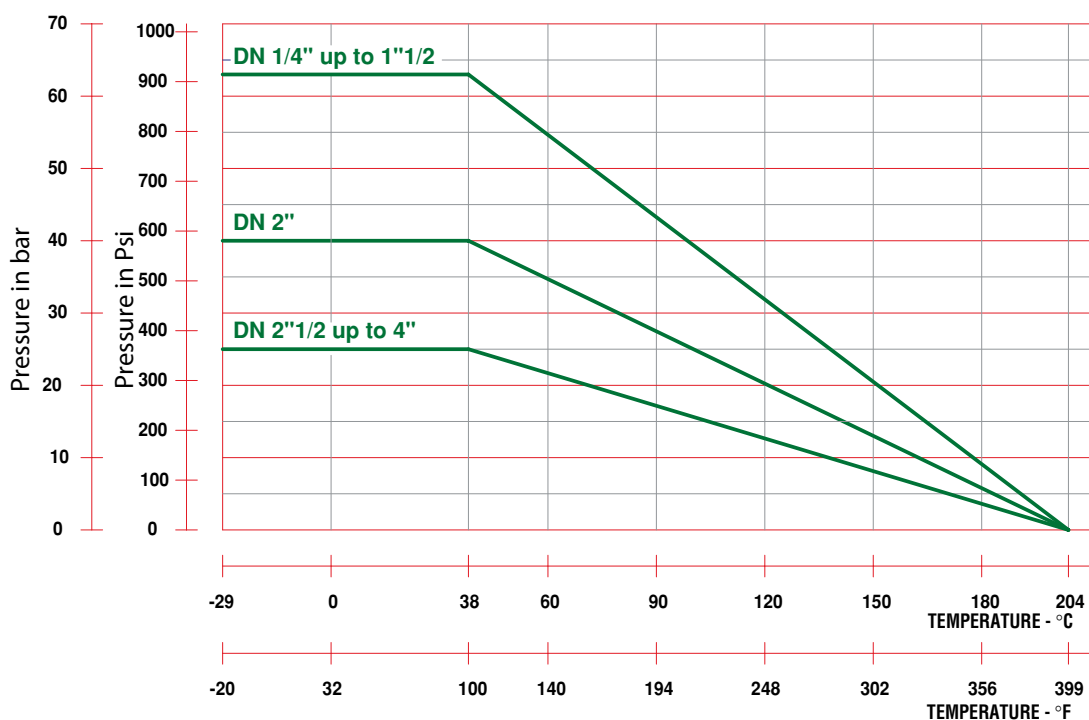

Socla can accept no responsibility for possible errors in catalogue, brochures and other printed material. Socla reserve the right to alter its products without notice. This also applies to products already agreed. All trademarks in this material are the property of the respective companies. All right reserved.

Socla SAS

365 rue du lieutenant Putier
71530 VIREY LE GRAND
Postal address : BP 10273
71107 CHALON SUR SAONE Cedex

Tel : 33 3 85 97 42 52
Fax : 33 3 85 97 97 42
<http://www.socla.com>
e-mail: commerfr@socla.com