

Technical data sheet

Type 402V Non return valve System 02

Applications and special features



- Operates in any position
- Minimum head loss
- Silent, reliable sealing, compact
- Exceptional robustness
- Does not generate hammering
- Closing system in stainless steel : long back axial guiding for reduced displacement
- Sealing guaranteed by a FKM flat seal
- Return spring

Technical description

Important notice :

The indicated pressure for the different categories of fluids (L1/L2/G1/G2) is under no condition a guarantee of use. Therefore, it is essential to validate the use of products under given operating conditions.

DN "	DN mm	PN	PFA in bar	PS in bar				Cat.	References	Vvs-nr
				L1	L2	G1	G2			
1 1/2	40	10/16	16	16	16	16	16	I	149B 2281 V	
2	50	10/16	16	16	16	16	16	I	149B 2346	
2 1/2	65	10/16	16	16	16	15	16	I	149B 2347	
3	80	10/16	16	16	16	12	16	I	149B 2348	
4	100	10/16	16	16	16	10	16	I	149B 2349	
5	125	10/16	16	16	16	0,5	16	I	149B 2226 V	
6	150	10/16	16	13	16	0,5	16	I	149B 2227 V	
8	200	10	10	10	10	0,5	10	I	149B 2229 V	
10	250	10	10	10	10	0,5	10	I	149B 2230 V	

- Connection : flanges drilled PN : see table
- Permissible operating pressure PFA - water- (for supply, distribution and disposal of water) : See table
- Maximum permissible pressure PS - other mediums : See table
- θ Mini. -10 °C
Maxi. 100 °C
- Mediums : Hydrocarbons, clear liquids, gas
- Approvals : PED 97/23/CE
- International construction Standards : CE Conformity Directive 97/23/CE
Flange drilling according to EN1092-2

Overall dimensions

DN		B	C	D	Weight
"	mm	mm	mm	mm	kg
1 1/2	40	85	80	150	4,2
2	50	100	97	165	5,8
2 1/2	65	120	125	185	8,1
3	80	140	150	200	10,2
4	100	170	187	220	14,5
5	125	200	220	250	24
6	150	230	260	285	32
8	200	288	340	340	53
10	250	354	420	405	94

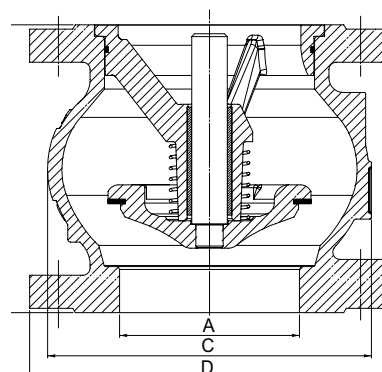

Technical data sheet Type 402V - Non return valve

Spare parts list and materials

Nb	Description	Materials	EURO	ANSI
1	CASING	Cast iron + epoxy	EN-GJL-250	ASTM A 48 35 B
2	RING	Bronze	CuSn12-C	
3	GUIDE DN50	Bronze	CuSn5Zn5Pb5-C	ASTM B 505
	Other DN	Cast iron + epoxy	EN-GJL-250	ASTM A 48 35 B
4	SPRING	Stainless steel	X10CrNi18-8	AISI 302
5	SEAL	FKM		
6	CLOSING SYSTEM DN40	Brass		
	DN50-65	Bronze	CuSn5Zn5Pb5-C	ASTM B 505
	Other DN	Cast iron + epoxy	EN-GJL-250	ASTM A 48 35 B
7	STEM DN40	Brass		
	Other DN	Bronze	CuSn5Zn5Pb5-C	ASTM B 505

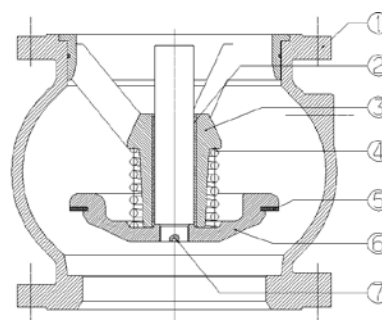

Working principle

DN	mm	Opening pressure in mm/CE				Kv	ζ
		↑	↓	↔	Without spring		
1 1/2	40	440	210	320	120	47,00	1,80
2	50	440	220	330	110	99,00	1,00
2 1/2	65	450	190	320	130	159,00	1,10
3	80	450	190	320	130	222,00	1,30
4	100	500	240	370	130	396,00	1,00
5	125	510	210	360	150	619,00	1,00
6	150	550	210	380	170	890,00	1,00
8	200	590	210	400	190	1120,00	2,00
10	250	710	210	460	250	2010,00	1,50

Directions for use :

- Solid line : Valve completely open
- Dotted line : opening stage of valve

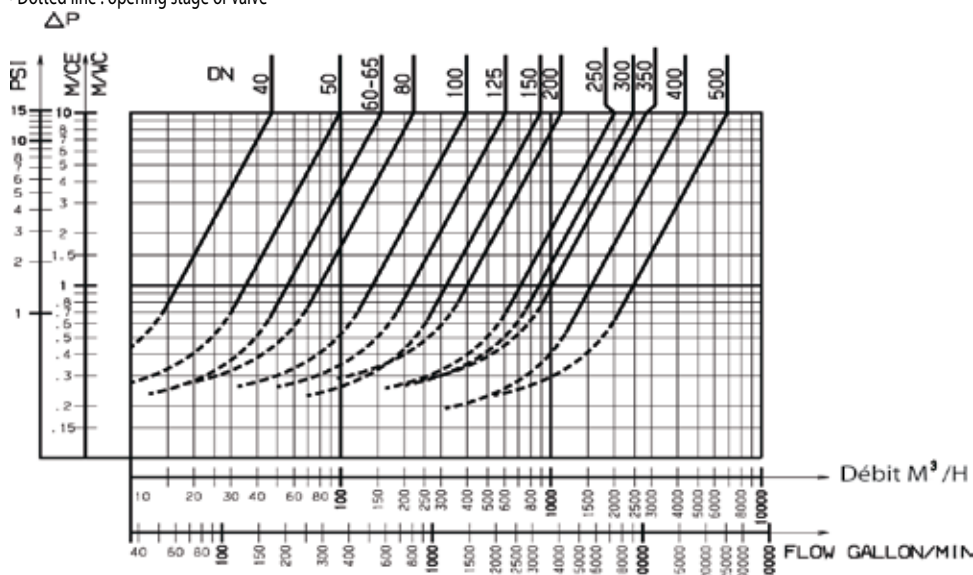

Socla can accept no responsibility for possible errors in catalogue, brochures and other printed material. Socla reserve the right to alter its products without notice. This also applies to products already agreed. All trademarks in this material are the property of the respective companies. All right reserved.

Socla SAS

365 rue du lieutenant Putier
71530 VIREY LE GRAND
Postal address : BP 10273
71107 CHALON SUR SAONE Cedex

Tel : 33 3 85 97 42 52
Fax : 33 3 85 97 97 42
<http://www.socla.com>
e-mail: commerfr@socla.com